

6.6 A Current Controlled Halogen - Reflector Lamps for Series Operation

Areas of application

- Airfield Lighting



Product features and benefits

- Low maintenance costs due to long lamp life
- Consistent light output over the life of the lamp
- Durable construction provides resistance to the effects of vibration
- IR radiation provides guidance in low visibility conditions and facilitates defrosting in cold climates
- FAA approved in conjunction with many OEM fixtures
- Dimmable
- Flicker-free operation
- Ability to reduce light output when needed
- Mercury-free

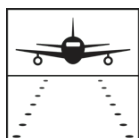



Connector A, female

PK30d Connector A female

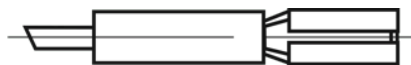

Connector B, female round

PK30d Connector B female round

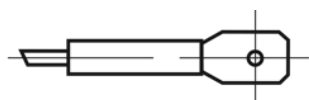

Connector C, male flat

PK30d Connector C male flat

Product family datasheet

Technical data

	Electrical Data	Lifetime Data
Product description	Nominal wattage	Nominal lifetime
64333 A 40-15	40 W	1500 hr
64333 B 40-15	40 W	1000 hr
64336 A 62-15	62 W	1500 hr
64337 A 45-15	45 W	1500 hr
64337 B 45-15	45 W	1500 hr
64339 A 105-10	105 W	1000 hr
64333 C 40-15	40 W	1500 hr
64337 A 48-15	48 W	1500 hr
64339 AC 105-10	105 W	1000 hr
64337 B 48-15	48 W	1500 hr
64337 C 48-15	48 W	1500 hr
64339 B 105-10	105 W	1000 hr
64339 C 105-10	105 W	1000 hr
64338 AC 48-10	48 W	1000 hr
64331 SP-A 30-10	30 W	1000 hr
64331 FL-A 30-10	30 W	1000 hr

Product family datasheet

Safety advice

To prevent personal injury or damage to property, halogen lamps may only be operated in suitable luminaires designed with suitable mechanisms (protective shields, grids, etc.) to ensure that in the event of a lamp bursting no parts/shards can escape and that during operation no ultraviolet radiation can escape. There must also be a warning sign to indicate that the lamps give off high levels of heat. Detailed information is available on request.

Application advice

For more detailed application information and graphics please see product datasheet.

Disclaimer

Subject to change without notice. Errors and omission excepted. Always make sure to use the most recent release.